

HyLED 9 Series

LED Surgical Lights

Technical Specifications

	HyLED 9700	HyLED 9500
Central illuminance (at 1m distance)	160,000 lux	120,000 lux
Light field diameter(at 1m distance)	195-330mm	195-330mm
Depth of illumination (L1+L2)	1,200mm	1,200mm
Color temperature	4,350K	4,350K
Color rendering index	95	95
Shadow dilution with tube	100%	100%
Shadow dilution with one mask	80% 90% (AICS function, Optional)	65%
Shadow dilution with tube and one mask	75% 85% (AICS function, Optional)	60%
Shadow dilution with two masks	60% 70% (AICS function, Optional)	55%
Shadow dilution with tube and two masks	55% 65% (AICS function, Optional)	50%
Radiant energy	3.6 mW/m ² *lux	3.6 mW/m ² *lux
Ambient illumination	12,800 lux	9,800 lux
Temperature rise-area around surgeon's head	≤1℃	≤1℃
Temperature rise-operative field	≤1℃	≤1℃
Service life of bulb	≥40,000h	≥40,000h
Bulb power consumption	200VA	150VA
Power supply	100VAC~240VAC,50/60Hz	100VAC~240VAC,50/60Hz
Automatic illumination control system	Optional	No

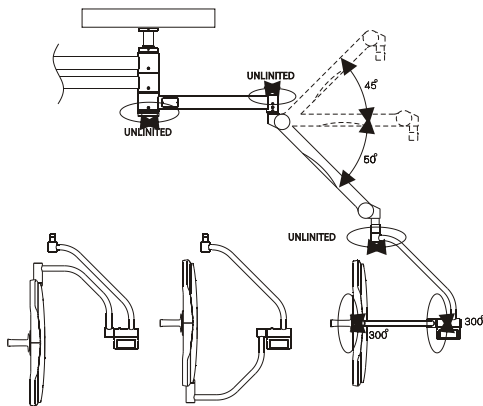

Maneuverability: Effortless, flexible, stable and durable. As powerful as it is, HyLED is light-weighted. Anyone can move and position it with ease. Four encircling grips are designed so that non-sterile personnel can assist the surgeon to adjust light position during the operating process as needed. With 6 joints, the light head can be moved to any position and angled to any direction. Once positioned, HyLED does not drift away. The whole suspension system is so reliably designed and robustly built that it is as good as new even after long-time servicing.



HyLED 9 Series

LED Surgical Lights

NEW

DISTRIBUTOR:



Mindray is the registered trademark owned by Shenzhen Mindray Bio-medical Electronics Co., LTD.
HyLED is the trademark owned by Nanjing Mindray Bio-medical Electronics Co., LTD
© 2010 Shenzhen Mindray Bio-Medical Electronics Co., Ltd. All rights Reserved.
P/N:ENG-HyLED--420285--20100811

mindray

Mindray is listed on the NYSE under the symbol "MR"
Mindray Building, Keji 12th Road South, High-tech Industrial Park,
Nanshan, Shenzhen 518057, P.R. China
Tel: +86 755 26582888 Fax: +86 755 26582680
E-mail: intl-market@mindray.com Website: www.mindray.com

mindray
healthcare within reach

HyLED 9 Series

LED Surgical Lights

Leading-edge technology of white LEDs

- Incredibly long service time up to 40,000 hours
- Excellent luminous efficiency
- Low power consumption
- Heat-free light source
- A maximum of central illumination 160,000 lux
- Maximum depth of illuminance up to 1,200mm
- Freely adjustable field diameter from 195mm to 330mm
- Optimum color temperature of 4,350K, with high color fidelity

A leading provider of professional OR solutions

Mindray is a leading developer, manufacturer and marketer of medical devices worldwide with the products of LED surgical lights, operating tables, and ceiling supply units.

With the leading-edge LED technology, HyLED series offer excellent luminous efficiency, heat-free

light source and incredibly long service time, which will give you total support in your ORs.

Mindray offers customized total solutions that optimize modern OR configuration and increase both clinical value and efficiency. We can provide all the devices in your ORs including:



Anesthesia Mounted Pendant



Ceiling Supply Beams



HyBase 6100 Operating Table



LED Surgical light



HyLED 9500 Mobile light



HyLite Halogen Surgical Light



BeneView T8
Patient Monitor



BeneHeart D6
Defibrillator / Monitor



WATO EX-65
Anesthesia Machine

HyLED 9 Series

LED Surgical Lights

>40,000 Hours

One of the main features of LEDs is their potentially very long life.

LED Lifetime Characteristics

How do the lifetime for today's white LEDs compare to traditional light sources?

Light Source	Hours
Halogen technology	1,000
Halogen with IRC technology	2,000
Xenon technology	5,000
LED technology	20,000–50,000 (L70)

Electrical and thermal design of the LED system or fixture determine how long LEDs will last and how much light they will provide. With improved electrical and thermal robustness of LEDs, HyLED service life is up to 40,000 hours, which is 40 times than halogen bulbs.

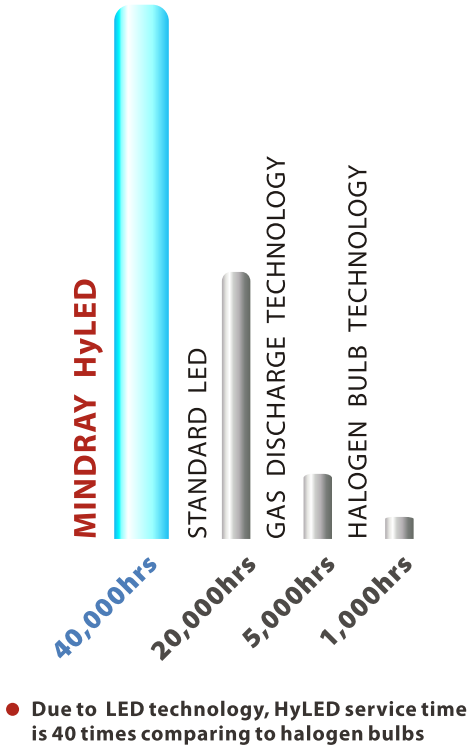

Intelligent AICS

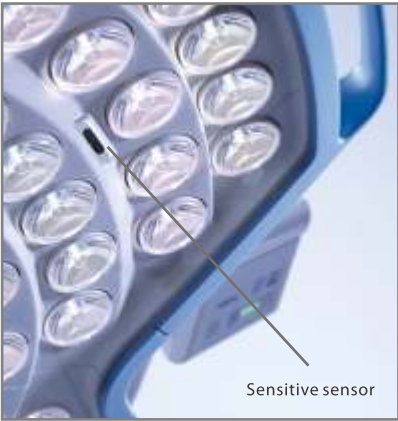

- Sensor control function: once the area is masked by surgeon's head, the lighting of the remaining zones are automatically boosted to maintain the consistent central illumination, so there is no need to make adjustments to the HyLED during a surgical procedure
- Safe and consistent lighting of the operating field
- Free movement of surgeons
- True shadow-free illumination
- Less heat around surgeon's head and the operative field, temperature rise less than 1°C

HyLED 9 Series

LED Surgical Lights

Ergonomical "Cross" Shape Design

This "Cross" shape of light head can be put in a proper position, which makes doctors' heads in the four corners. And it also can provide you a homogeneous light beam & light patch, just like the picture shows you.

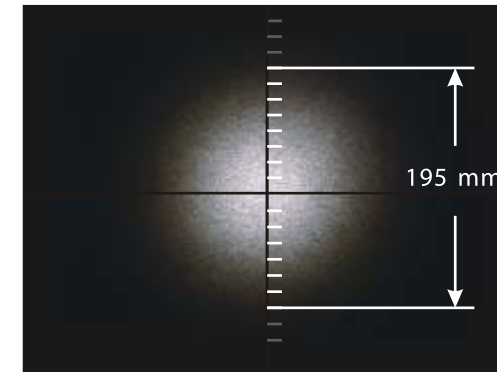

Minimum light field diameter of 195mm

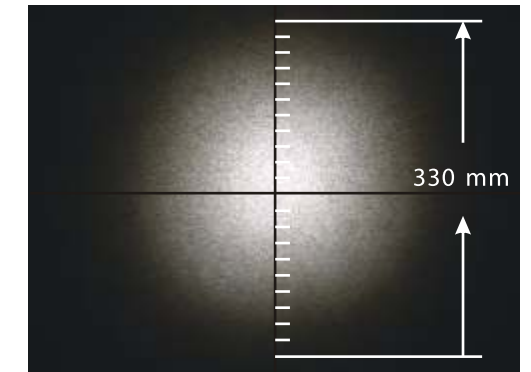

Maximum light field diameter of 330 mm

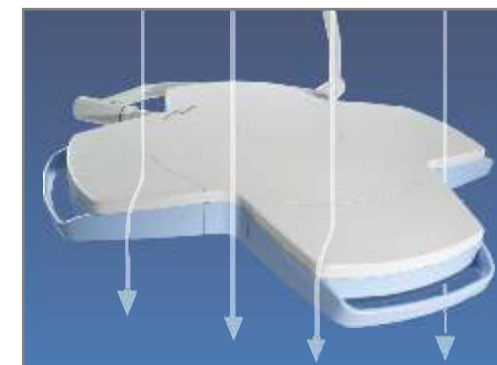

Optimized air flow design for better hygiene

HyLED generates minimized turbulence in the laminar flow in two ways: first its cross shape design ideally matches with laminar flow; second, its low power consumption and excellent heat dissipation make the warming effect on the outer surface is really low. So, HyLED creates optimum operating conditions and fulfills hygiene requirements.



High quality and efficient LED bulb in the light head

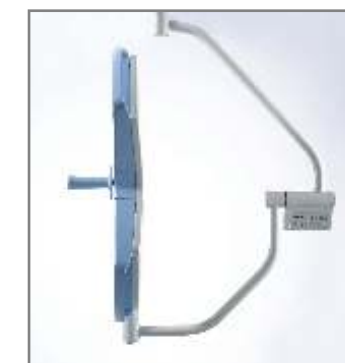

Really thin, the lateral profile of the light head



Excellent heat dissipation of the light head

HyLED 9 Series
LED Surgical Lights

2,000,000 Pixel HD Camera



Carrier Arm Camera	
Picture Elements	2,000,000 Pixels
Optical Zoom	10X (f=5.1-50.1mm, F=1.8-2.1)
Digital Zoom	12X(120X with optical zoom)
S/N Ratio	>50dB
Electric shutter	1/2-1/10000s
Video Output	Component

Modern medicine, to a large extent, depends on interdisciplinary exchanges of diagnostic data and expert opinions. Therefore, an integrated data transmission system that delivers information beyond spatial limitations has become an indispensable part of the future-oriented healthcare institutions.

Mindray's integrated video system serves the exact purpose. With the HD camera that features 2,000,000 pixels and the comprehensive broadcasting network that links people everywhere, it enables communications inside and outside the institution, and for training and consultations.

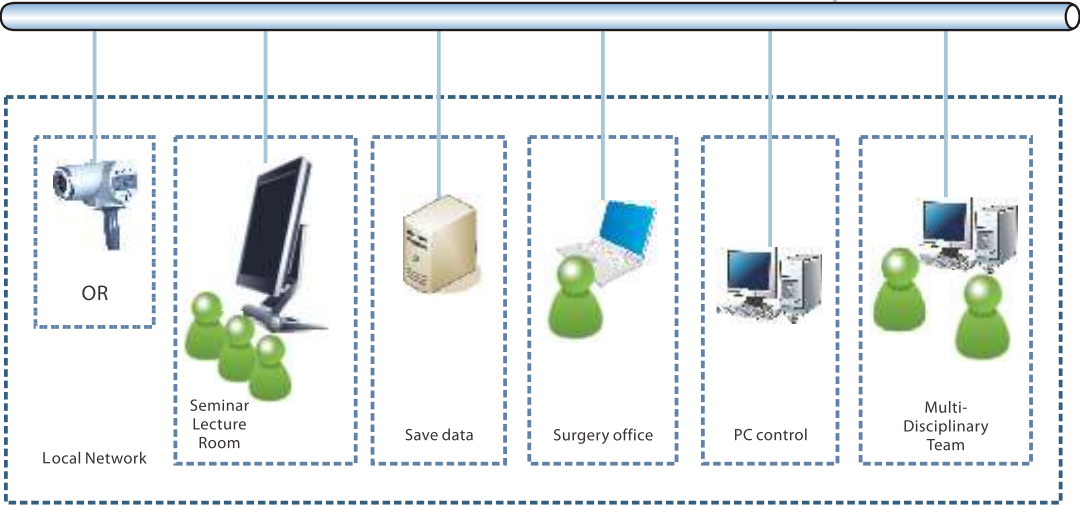
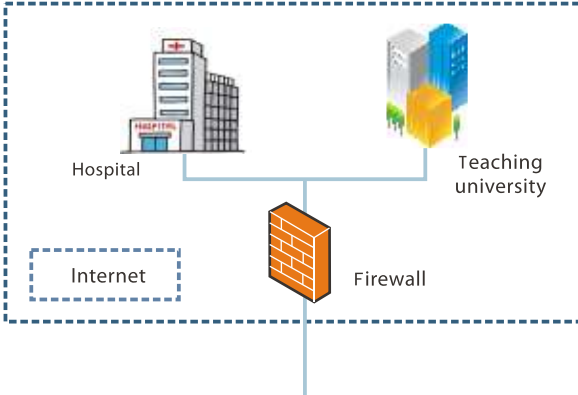

Mindray OR Total Solution —— Welcome to Mindray showroom

All the advanced and reliable facilities from Mindray technology, are perfectly matched to give you total support !

